

Shopping Script  
is made after and inspired by  
my handwritten shopping list  
that was originally a lot  
less stylish...  
This is a Guide on how to  
make the most out of its Open  
Type Features!

# Shopping Script Variable

by @rolandhusedesign

Tabasco  
Mustard

Beef Fr  
Chicken  
Salmon  
green

Be  
Water  
Vodka

Tomato  
Raddish  
Spinach  
berries  
almond  
apple



# Standard Ligatures

i-t it  
j-t jt  
l-l ll  
s-l sl  
t-t tt

From the Open Type of the Character menu, make sure you have the **"Standard Ligatures"** tab enabled to activate these ligatures:

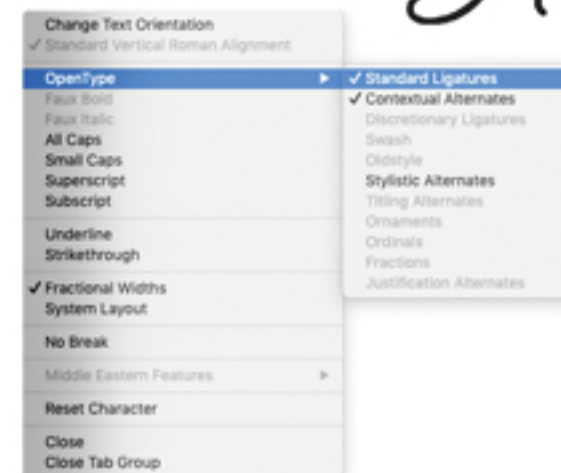

Hello

# Stylistic Alternates

A - A  
e - e

1. To switch between these characters, you can enable **"Stylistic Alternates"** from the **Character** menu's **Open Type** tab:

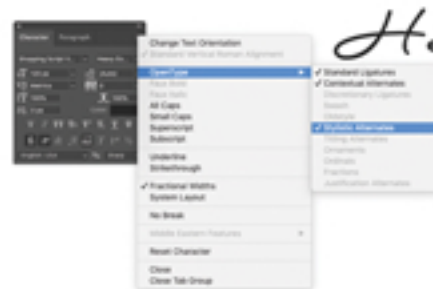

Hello

2. Alternatively, if you just want to apply individual letters, that is better to highlight the letter and switch to its alternate by double clicking on it in the dropdown selection:



# Contextual Alternates (initial forms)

r - r  
s - s

1. To activate a "starting character", when a lowercase "r" or "s" is at the beginning of a word, enable **"Contextual Alternates"** from the **Character** menu's **Open Type** tab:



2. Alternatively, you can apply to it manually; just highlight the letter and switch to its alternate by double clicking on it in the dropdown selection:

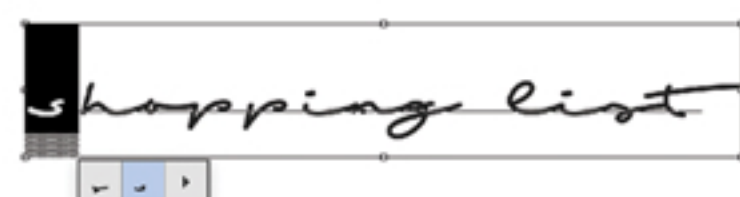

# Weights & Widths

## FONT FAMILY

Thin Condensed

Thin

Light Condensed

Light

Regular Condensed

Regular

Bold Condensed

Bold Condensed

Heavy Condensed

Heavy Condensed

Thin Expanded

Light Expanded

Regular Expanded

Bold Expanded

Heavy Expanded

## VARIABLE FONT

Thin Condensed - Heavy Expanded

1. If you would like to use the variable font and set the thickness and width manually, select any instance for example "Shopping Script Variable Thin Condensed", then go to the top menu bar (in **Photoshop**) and select "Window". From the dropdown, choose "Properties". Now you can find a slider with values for "Weight" and "Width" in a new window that you can adjust as you like:

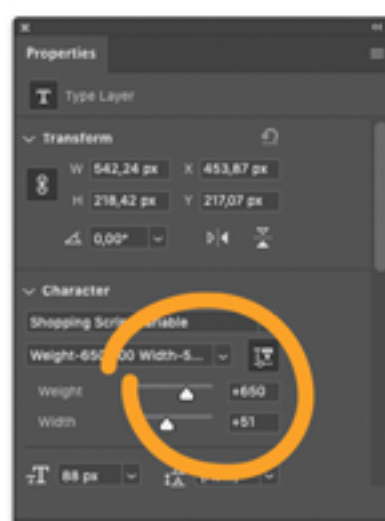

2. In **Illustrator**, when you have the font selected in the top menubar, a small icon "TT" should appear on the right, between the instance and the font size that says "Variable Font" while hovering over with the mouse. Now you can see the slider with values for "Weight" and "Width" in a new window that drops down when clicking on the TT icon. Adjust any in between instance as you like:

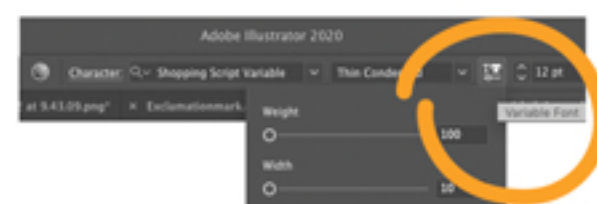

# Character Set

## UPPERCASE LETTERS

A Á Â Ã Ä Å Æ Ç  
C Ć Č Ď Đ Ę Ğ Ħ Ĩ Ĵ  
Š Š Ś H # O Ó Ô Õ Ö Ø Ž K  
L Ł Ł' Ł Ł N Ń Ň Ny Ñ O Ó Ô Õ Ö Ø Ø Æ  
P Q R Ĳ Ŗ S Š Š Š Š T † ‡ ‹  
U Ú û ü ù ů v w ų ŵ ŷ W X  
Y Ý Ŷ Ÿ Z Ż ż ž

LOWERCASE LETTERS

á â ã ä å à á â ã ä å æ ç è é ê ë ì í î ï ð ñ ò ó ô õ ö ø ù ú û ü ý þ ÿ ÿ ÿ ÿ ÿ ÿ ÿ ÿ ÿ  
í î ï ð ñ ò ó ô õ ö ø ù ú û ü ý þ ÿ ÿ ÿ ÿ ÿ ÿ ÿ ÿ ÿ  
r r q r i c , o o s s , B T T T T  
u u u u u u u u v w x y z z z z z z z z

## NUMBERS AND SYMBOLS

0123456789

€ ¤ ¥ £ ¤ + - × ÷ = > < ~ ^ © & ¶ § © ® ™ ||





Thank You!